

# Redmi Note 10 JE

## XIG02

### Quick Start Guide

For disclaimers, refer to "Notes on Usage".  
Descriptions in this manual are based on  
Android™ 11.

For the latest edition, refer to "取扱説明書  
(Instruction manual)" (Japanese) available on  
your carrier's homepage.

# Names and functions of parts

---

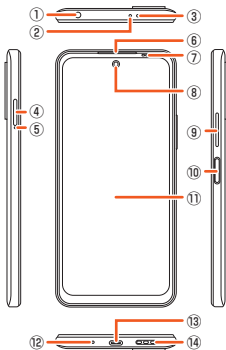

- ① Headset connection terminal
- ② Infrared sensor
- ③ Second microphone\*<sup>1</sup>  
Reduces noise for calling.
- ④ microSD memory card/SIM card tray
- ⑤ Tray removal hole
- ⑥ Earpiece/Speaker
- ⑦ Proximity sensor/Light sensor\*<sup>2</sup>
- ⑧ Front camera
- ⑨ Volume key
- ⑩ Power key/Fingerprint recognition sensor\*<sup>2</sup>
- ⑪ Display (Touch panel)\*<sup>3</sup>
- ⑫ Mouthpiece/Microphone\*<sup>1</sup>
- ⑬ USB Type-C™ connection terminal
- ⑭ Speaker

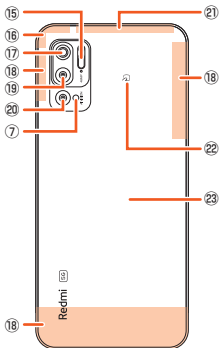

- |   |                            |
|---|----------------------------|
| ⑮ Flash/Light                                     | ⑳ Macro camera             |
| ⑯ Wi-Fi®/GPS/<br>Bluetooth® antenna* <sup>4</sup> | ㉑ 4G antenna* <sup>4</sup> |
| ⑰ Primary camera                                  | ㉒ NFC antenna<br>location  |
| ⑱ 4G/5G antenna* <sup>4</sup>                     | ㉓ Back panel* <sup>5</sup> |
| ⑲ Depth camera                                    |                            |

- \*1 Do not jab with a sharp object such as a needle. Doing so may cause a malfunction.
- \*2 Note that covering these parts with stickers or fingers, etc. may hinder product performance.
- \*3 The display has a protective sheet (complimentary sample) already adhered.
- \*4 The antenna is built into the main unit. Covering around the antenna by your hand may affect the quality of call/communication.
- \*5 The back panel is not removable. Trying to remove case may cause breakage or malfunction. Battery is built in and is not removable.

# Attaching SIM card

---

Before attaching SIM card, make sure to turn off the product.

- 1 Insert SIM removal pin (complimentary sample) into tray removal hole straight**

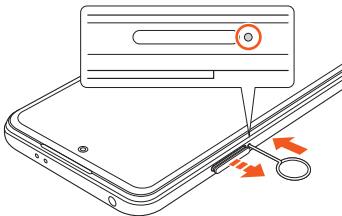

- 2 Pull out microSD memory card/SIM card tray straight**

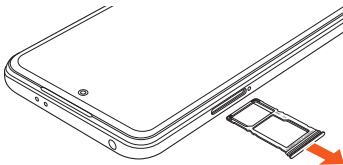

**3 Hold the SIM card with its IC (metal) chip downward and insert in microSD memory card/SIM card tray**

Note location of notch.

Make sure SIM card is in tray securely.

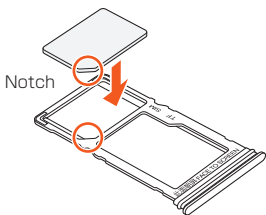

**4 Press microSD memory card/SIM card tray straight into the product**

Make sure there is no gap between the main unit and the microSD memory card/SD card slot cover.

# Turning the power on/off

---

## ■ Turning the power on

- 1 Long-press the power key for at least 4 seconds**

The lock screen appears.

Swipe (flick) the screen to unlock. An initial settings wizard appears the first time the product is powered on after purchase.

Follow the onscreen instructions to set functions.

## ■ Turning the power off

- 1 With screen on, long-press the power key for at least 2 seconds**
- 2 [Power off] → [Tap to Power off]**

## ■ Forcing the product to turn off and restart

- 1 Long-press the power key for at least 10 seconds**

# Switching to English Display

---

Switch the language displayed on the screen to English.

**1** Home screen → [設定 (Settings)] → [追加設定 (Additional settings)] → [言語と入力 (Languages & input)] → [言語 (Languages)]

**2** [English]

The message "起動中のアプリ、メール送受信、ダウンロードなどが終了される場合があります。"

(Applications, mail transmission/reception, and downloads may be terminated.)

appears, confirm the content and then tap [OK].

# Packaged items

---

Before you start using the product, make sure that you have all these packaged items with the product.

- Main unit (protective sheet (complimentary sample) pre-adhered)
- Soft case (complimentary sample)

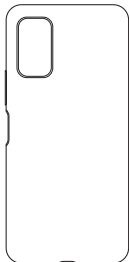

- SIM removal pin (complimentary sample)



- クイックスタートガイド (Quick Start Guide) (Japanese)
- ご利用にあたっての注意事項 (Notes on Usage) (Japanese)

These items are not included in the package.

- microSD memory card
- Earphones
- AC adapter
- USB Type-C cable





---

## memo

---

- Purchase a specified charger (sold separately).
- The battery is built into the product.
- Illustrations used in this manual are just images for explanations. They may be different from actual ones.



モバイル・リサイクル・ネットワーク  
携帯電話・PHSのリサイクルにご協力を。

Mobile phone and PHS operators collect and recycle unused telephones, batteries and battery chargers at stores bearing the ♻️ logo regardless of brand and manufacturer to protect the environment and reuse valuable resources.



やめましょう、  
歩きスマホ。



キケン！  
水ぬれ充電



あぶない！  
電池への衝撃

Importer: Xiaomi Technology Japan Co., Ltd.  
Manufacturer: Xiaomi Communications Co., Ltd.

August 2021, 1st Edition